

Car jack PF2

Maximum load 860daN
Minimum loading height 90mm
Maximum loading height 325mm
Weight 1,8kg



Car jack A7

Maximum load 840daN
Minimum loading height 90mm
Maximum loading height 290mm
Weight 1,8kg



Car jack T5

Maximum load 700daN
Minimum loading height 70mm
Maximum loading height 350mm
Weight 1,7kg



Jack 4400

Maximum load: 700daN
Maximum loading height: 358mm
Weight: 1.48kg



Distant holder for Toolbox C2/1007

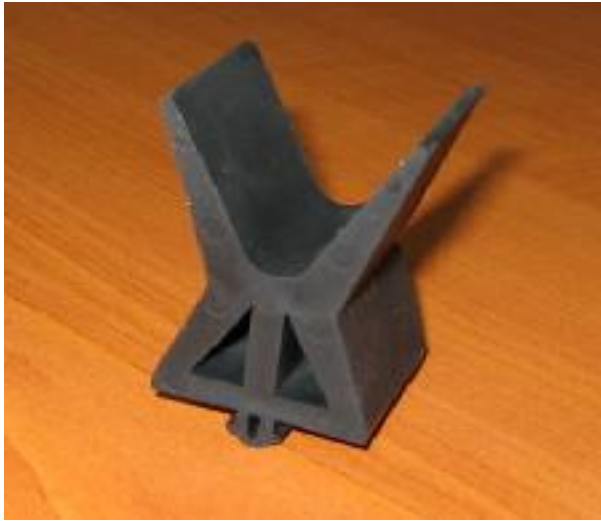

Distant lever BAR A7

Distant lever for front suspension for Peugeot 1007



Jack 188S

Maximum load: 700daN

Max. loading height: 341mm

Min. loading height: 100mm

Weight: 1.8kg



Toolbox C2/1007

Plastic toolbox for car jack and tools for Citroen C2 and Peugeot 1007

